



PAV-14 & 16 - Rotary Airlock

HEAVY DUTY SERIES ROTARY AIRLOCK VALVE



AVAILABLE FEATURES



- Air purged seals
- Food grade Teflon seals
- Food grade white epoxy paint
- 304 or 316 stainless steel body & rotor
- Hastelloy body and rotor
- Shear pins / Zero speed switch
- High temp bearings & seals for operation to 1100° F
- Wear & corrosion resistant coatings
- Inlet baffle / Inlet v-plow for shear protection
- Discharge adapter / Finger guards
- Bolt on or flexible tips
- Vented pockets / Vented housing
- Die cut flange gaskets
- Manual hand crank or pneumatic maintenance gates available
- Drive: TEFC, or TEXP / Various voltages available

NFPA-69
MSHA
V-Plow
10-Bar
PSR11
CSA

PRATER 14" & 16" ROTARY AIRLOCKS

- Constructed of high strength cast iron or stainless steel body & end plates
- 8 blade, mild steel, open-end rotor with welded pocket bottoms
- Self-adjusting, maintenance-free packing gland assemblies
- Outboard mounted, maintenance-free bearings
- Universal flanges custom-drilled at no extra charge
- Complimentary temperature compensation
- End plates pre-drilled & tapped for optional shaft air purge
- Quick and easy end plate removal using included jack bolt holes
- Operating temperature up to 500° F with standard components
- Keyed shaft extension for most drive assemblies
- Premium, inverter duty, helical gear motor
- Standard models in stock

**THE ONLY AIRLOCK
IN NORTH AMERICA TO BE
TESTED & CERTIFIED
TO COMPLY WITH NFPA-69**



praterindustries.com

Housing:

Material: Gray Cast Iron
 Thickness: 0.875" x 0.31" (22.2 x 7.9 mm)

Flanges:

Square Outline: Drilled
 Round or Square

Bearings:

Type: Ball Bearing
 Size: 2.688" / 68.3 mm
 Life Rating L-10: > 60,000 hours
 Outboard Mounted: Yes

Shaft:

Material: Mild or Stainless Steel
 Drive Stub Shaft D: 1.94" / 49.3 mm
 Packing Seal: Abrasion Resistant

CAPACITY:

PAV-14
 Theoretical: 1.475 cu. Ft. (41.77 L) / rev.
 Practical: 1.18 cu. Ft. (33.41 L) / rev.

PAV-16

Theoretical: 2.3 cu. Ft. (65.13 L) / rev.
 Practical: 1.84 cu. Ft. (52.10 L) / rev.

DRIVE INCLUDES:

PAV-14
 2.0 Hp, 60Hz, 3 Ph
 230/460 V. Motor, Motor Base
 Gear Reducer, Chain Drive
 TEFC & OSHA Guard

PAV-16

3.0 Hp, 60Hz, 3 Ph
 230/460 V. Motor, Motor Base
 Gear Reducer, Chain Drive
 TEFC & OSHA Guard

APPROX. WEIGHT & DIMENSIONS:

PAV-14 - Airlock Only
 Weight: 620 lbs / 281 kg
 Shipping Weight: 665 lbs / 302 kg

PAV-16 - Airlock Only

Weight: 720 lbs / 327 kg
 Shipping Weight: 760 lbs / 345 kg

PAV-14 - With Drive & Guard

Weight: 765 lbs / 347 kg
 Shipping Weight: 810 lbs / 368 kg

PAV-16 - With Drive & Guard

Weight: 840 lbs / 381 kg
 Shipping Weight: 885 lbs / 402 kg

Sound Level:

< 75 db scale A

Paint:

Primer: Gray Chromate
 Finish: White, Urethane

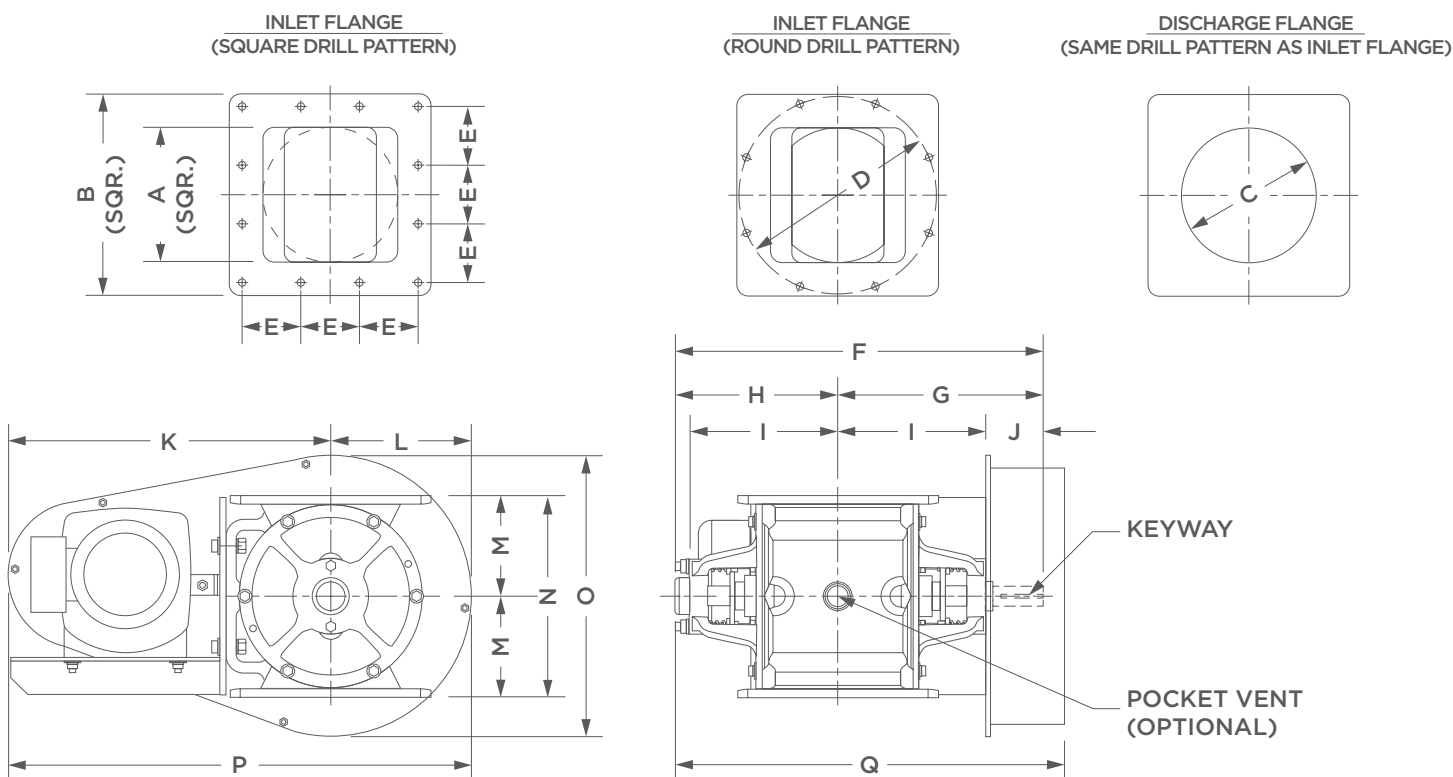

MODEL	DISPLACEMENT (CU. FT./REV)	DIMENSIONS (IN)															HOLE (QTY)	KEYWAY W X D	DRIVE SHAFT DIA.	FLANGE THK.	WEIGHT (LBS)	WEIGHT W/ DRIVE (LBS)		
		A	B	C	D	E	F	G	H	I	J	K	L	M	N	O							P	Q
PAV-14	1.475	14	19	14	18 3/4	4 1/4	15 21/32	21	2 7/16	16 11/16	14 1/4	35 1/8	10 1/2	10 1/8	20 1/4	32 3/8	38 5/8	34	12	1/2 x 1/4	1 15/16	5/8	620	765
PAV-16	2.30	16	22	16	21 1/2	5	15 15/16	23 1/2	2 7/16	17 23/32	15 1/4	36 13/32	11	11 7/16	22 7/8	33 21/32	39 7/8	39 7/32	12	1/2 x 1/4	1 15/16	3/4	720	840



2 Sammons Court, Bolingbrook, IL 60440
 1-877-AIRLOCK (247-5625) • praterindustries.com