



PAV-6 - Rotary Airlock

HEAVY DUTY SERIES ROTARY AIRLOCK VALVE



PRATER 6" ROTARY AIRLOCK

AVAILABLE FEATURES

- Air purged seals
- Food grade Teflon seals
- Food grade white epoxy paint
- 304 or 316 stainless steel body & rotor
- Hastelloy body and rotor
- Shear pins / Zero speed switch
- High temp bearings & seals for operation to 1100° F
- Wear & corrosion resistant coatings
- Inlet baffle / Inlet v-plow for shear protection
- Discharge adapter / Finger guards
- Bolt on or flexible tips
- Vented pockets / Vented housing
- Die cut flange gaskets
- Manual hand crank or pneumatic maintenance gates available
- Drive: 1/2 HP, TEFC, or TEXP / Various voltages available



- Constructed of high strength cast iron or stainless steel body & end plates
- 8 blade, mild steel, open-end rotor with welded pocket bottoms
- Self-adjusting, maintenance-free packing gland assemblies
- Outboard mounted, maintenance-free bearings
- Universal flanges custom-drilled at no extra charge
- Complimentary temperature compensation
- End plates pre-drilled & tapped for optional shaft air purge
- Quick and easy end plate removal using included jack bolt holes
- Operating temperature up to 500° F with standard components
- Keyed shaft extension for most drive assemblies
- Premium, 1/2 HP, inverter duty, helical gear motor
- Standard models in stock

NFPA-69
MSHA
V-Plow
10-Bar
PSR11
CSA

**THE ONLY AIRLOCK
 IN NORTH AMERICA TO BE
 TESTED & CERTIFIED
 TO COMPLY WITH NFPA-69**



praterindustries.com

Capacity:

Theoretical: 0.15 cu. Ft.
(4.3 L) / rev.
Practical: 0.12 cu. Ft.
(3.4 L) / rev.

Housing:

Material: Gray Cast Iron
Thickness: 0.38" x 0.31"
9.5 x 7.9 mm

Flanges:

Square Outline: Drilled
Round or Square
Inlet Size: 6.0" / 152 mm
Outlet Size: 6.0" / 152 mm
Thickness: 0.31" / 7.9 mm

Bearings:

Type: Ball Bearing
Size: 1.0" / 25.4 mm
Life Rating L-10: > 60,000 hours
Outboard Mounted: Yes

Shaft:

Material: Mild or Stainless Steel
Drive Stub Shaft D: 1.00" / 25.4 mm
Packing Seal: Abrasion Resistant

Drive Includes:

0.5 Hp, 60Hz, 3 Ph
230/460 V. Motor, Motor Base
Gear Reducer, Chain Drive
TEFC & OSHA Guard

**Approx. Weight & Dimensions:
Airlock Only**

Length: 19-3/8" / 492 mm
Width: 10.0" / 254 mm
Height: 10.0" / 254 mm
Weight: 70 lbs / 32 kg
Shipping Weight: 90 lbs / 41 kg

With Drive & Standard Guard:

Length: 27-1/4" / 692 mm
Width: 27-1/16" / 687 mm
Height: 16-3/4" / 425 mm
Weight: 145 lbs / 66 kg
Shipping Weight: 180 lbs / 82 kg

Sound Level:

< 75 db scale A

Paint:

Primer: Gray Chromate
Finish: White, Urethane

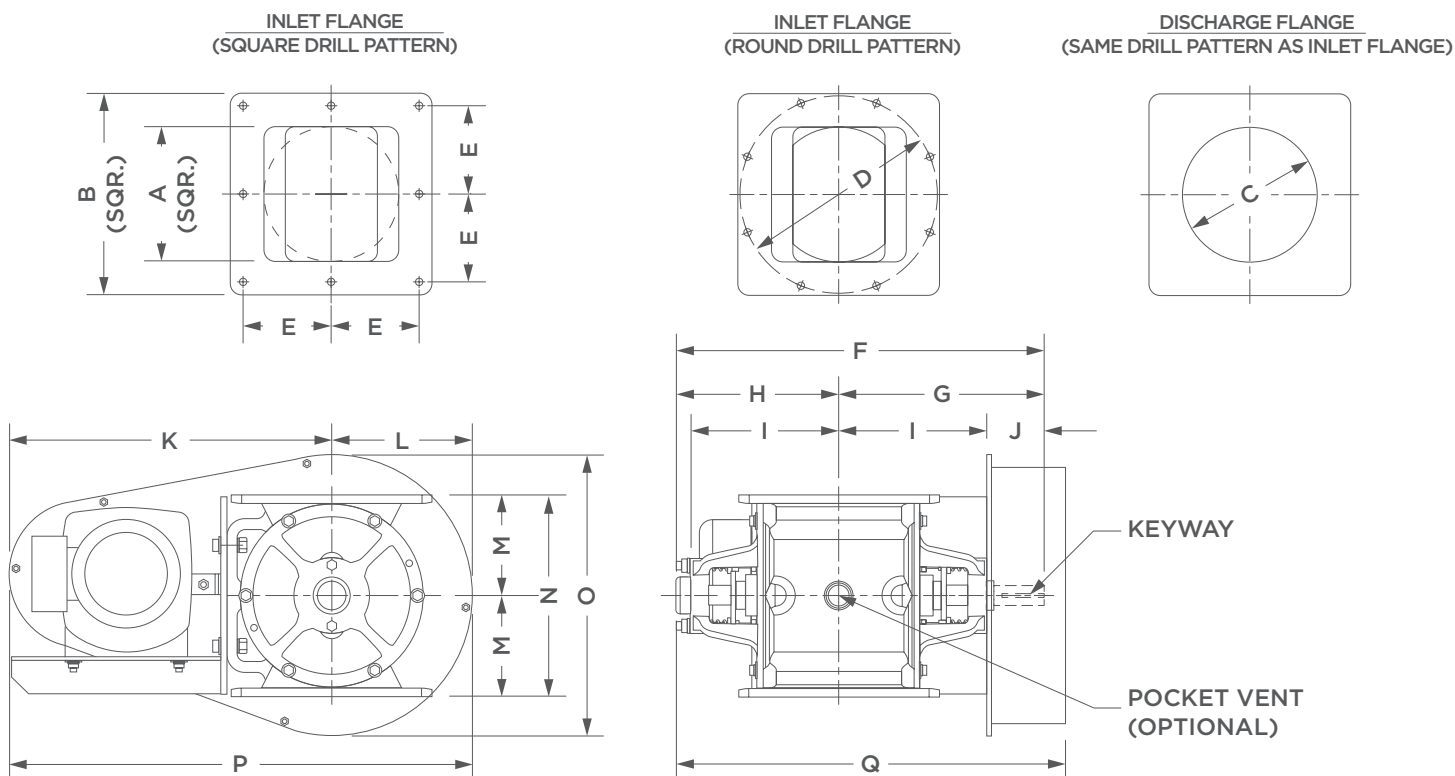

MODEL	DISPLACEMENT (CU. FT./REV)	DIMENSIONS (INCHES)														HOLE (QTY)	KEYWAY W X D	DRIVE SHAFT DIA.	FLANGE THK.	WEIGHT (LBS)	WEIGHT W/ DRIVE (LBS)			
		A	B	C	D	E	F	G	H	I	J	K	L	M	N							O	P	Q
PAV-6	.15	6	10	6	9 1/2	4 5/16	19 3/8	10 11/16	8 11/16	7 13/16	2 1/2	19 1/4	8 3/8	5	10	16 3/4	27 1/4	21 1/16	8	1/4 x 1/8	1	5/16	70	145



2 Sammons Court, Bolingbrook, IL 60440
1-877-AIRLOCK (247-5625) • praterindustries.com